

# Installation Guide

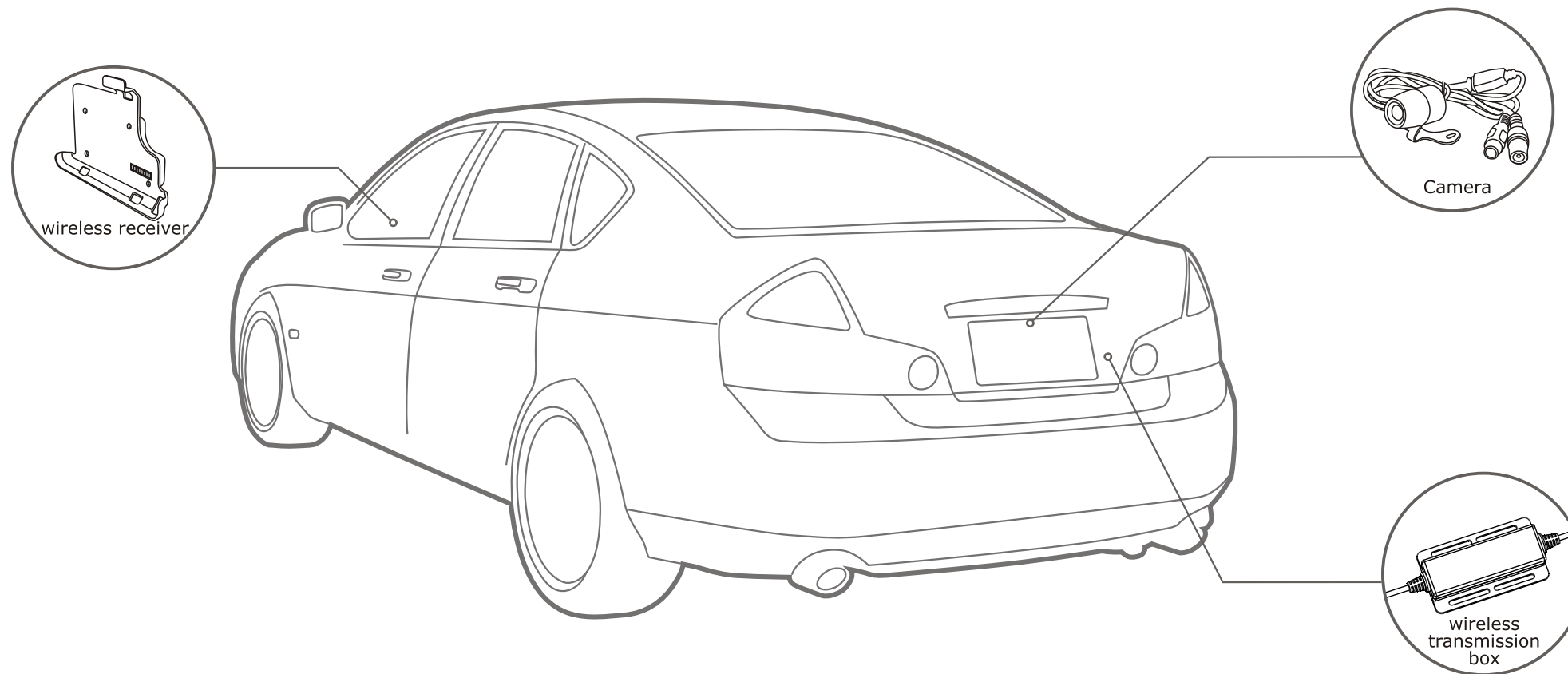

Please read this Installation Guide carefully before using this product.

## Specification

camera	Imaging Sensor	CMOS
	CMOS Total Pixels	628x586(PAL);510x496(NTSC)
	Video Format	NTSC/PAL
	Minimum illumination	0 Lux
	Power Supply	12V <sub>DC</sub>
	Consumption Current(Max.)	90mA
	Dimensions( W x D x H)	36 x 47 x 33(mm)
receiver	Weight(about)	60g
	Receiving frequency	ISM2,400MHz ~2,483MHz
	Demodulation type	FM
	Video output polarity	Negative
	Receiving sensitivity	≤ -85dBm
	Transmission range	50 meters
	Frequency Stability	±100 ppm
	Operating temperature	-10°C ~+50°C/+14°F ~ +122°F
	Operating Humidity	85%RH

## Transmission box connect diagram

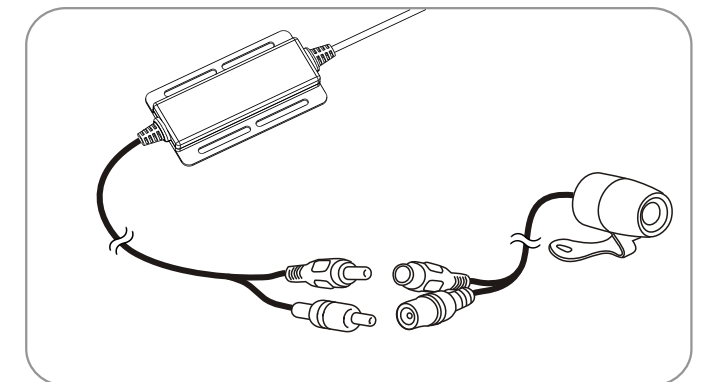

1. Connect the transmission box to camera.

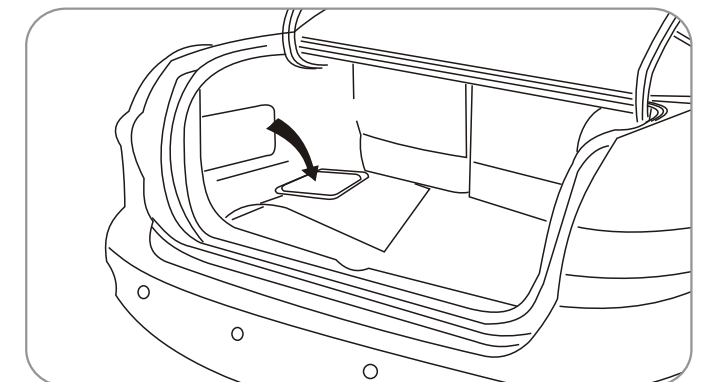

2. Install the transmission box in the appropriate position

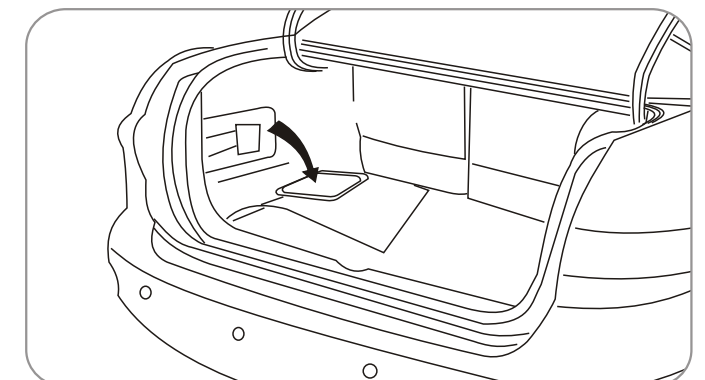

3. Find out the power of the reverse light, and connect it to the transmission box.

## Packing list

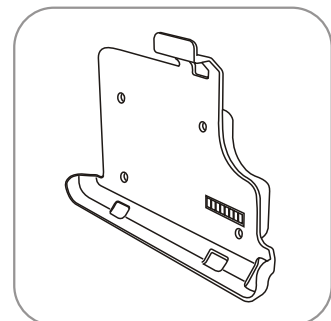

receiver

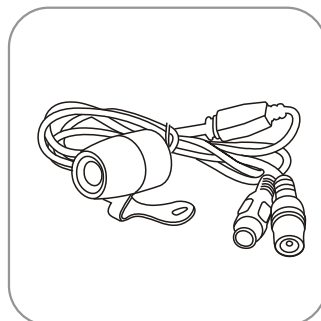

camera

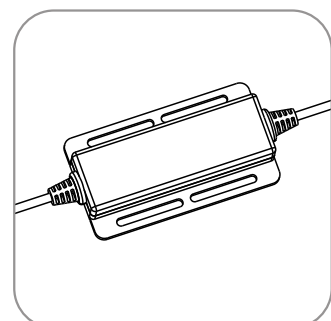

transmission box

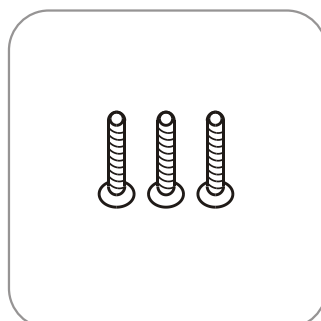

sheet screws

## Install the Camera

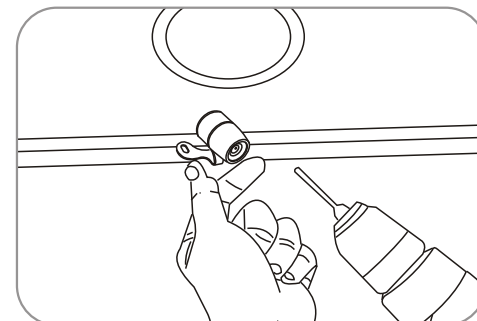

1. Drill one hole for installation sheet screw.

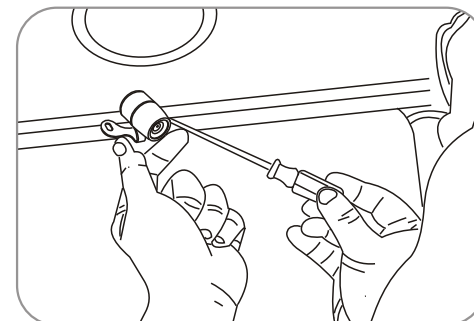

2. Install the first sheet screw.

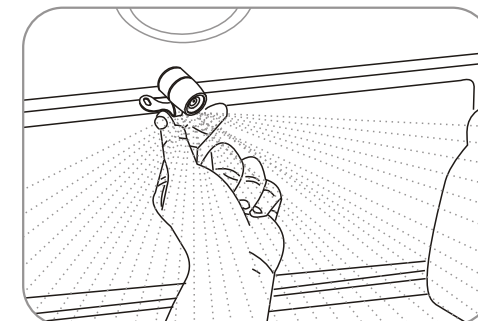

3. Adjust the camera to a suitable angle.

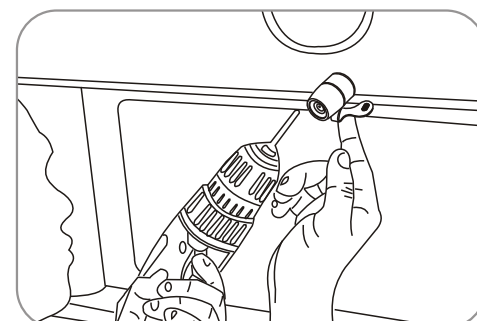

4. Drill the second hole for installation sheet screw.

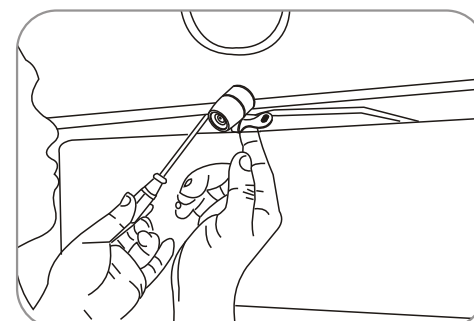

5. Install the second sheet screw. Installation finished.